

REV	DESCRIPTION	DATE
4.20	NEW DRAWING FRAME	2023/07/03
4.30	CORRECT INSULATION RESISTANCE	2023/11/16

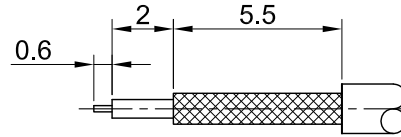

RECOMMENDED STRIP LENGTHS

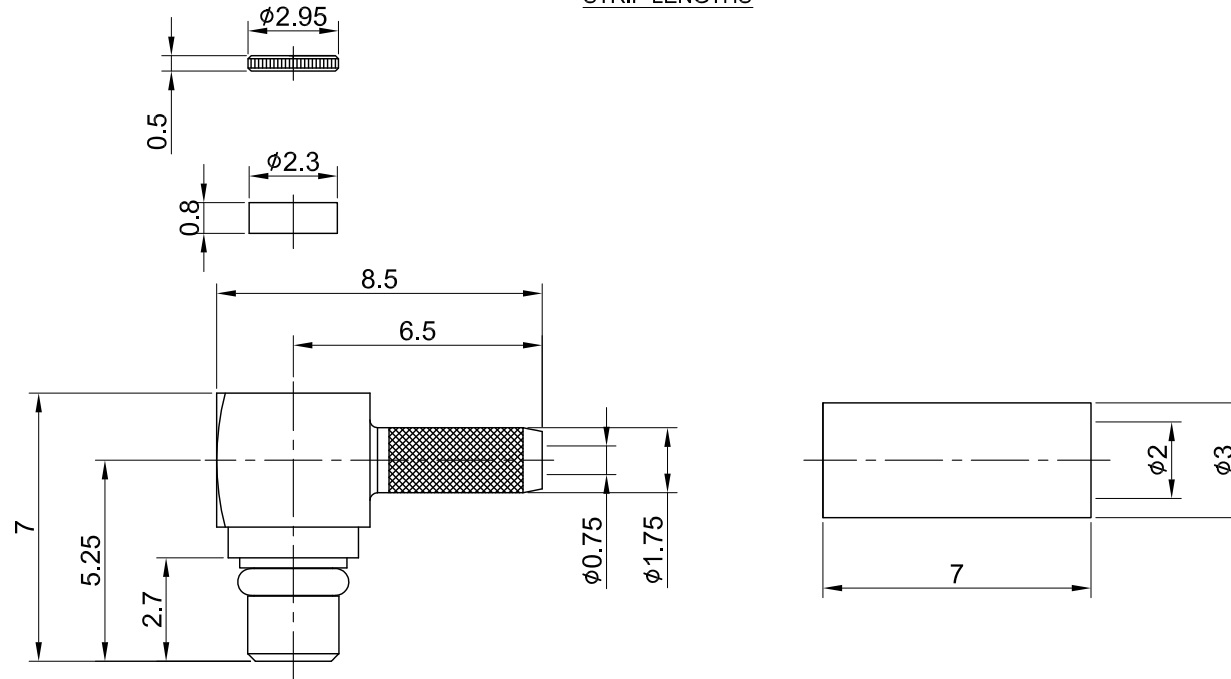

MECHANICAL DATA
TEMPERATURE RANGE : -40°C ~ + 85°C

ELECTRICAL DATA
FREQUENCY RANGE: DC~6GHz
IMPEDANCE : 50Ω
VSWR : 1.3 MAX.
WORKING VOLTAGE : AC 170V
WITHSTANDING VOLTAGE : AC 500V
INSULATION RESISTANCE : 1000 MΩ MIN

07	FERRULE	BRASS	GOLD	1
06	CENTER PIN	BRASS	GOLD	1
05	C-RING	Be.CU	GOLD	1
04	INSULATOR B	TEFLON	NONE	1
03	BODY	BRASS	GOLD	1
02	INSULATOR A	POM	NONE	1
01	COVER	BRASS	GOLD	1
NO	DESCRIPTION	MATERIAL	FINISH	Q'TY

TITLE		DRAWN BY:	
MMCX(M) ra. crimp for 1.32(single shield)		Lottie	2023/11/16
DWG NO. C05BA3F132001		CHK'D BY:	Kana 2023/11/16
CUST. P/N: N/A DWG NO: N/A			
SHEET 1 of 1 Unit: mm		GENERAL TOLERANCES	REVISION
		.X ±0.2 .XX ±0.2 .XXX ±0.2 ANGLES N/A	 DA2311150031 4.30